



The Insider Balloon Stuffing Tool

Instruction Sheet

Includes:

- 1 Inflation Tool or 10ft Ext. Hose & Trigger Valve
- 1 Holding Tool
- 1 Air Hose
- 1 C-Clamp

Models:

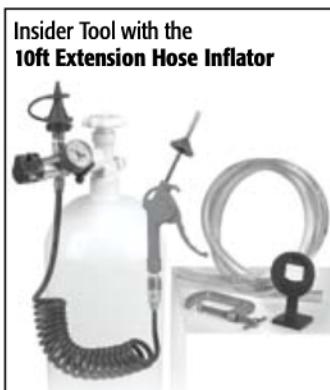

Set-up

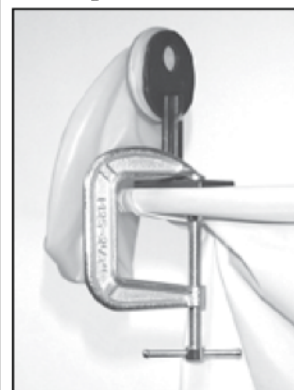

1. Clamp the Insider Balloon Stuffing Tool to the edge of a table with the yellow square facing out.

2. Roll the neck of a large balloon down and stretch the balloon over the rim of the Insider. Make sure the balloon is centered on the Insider tool.

Stuffing the Large Balloon

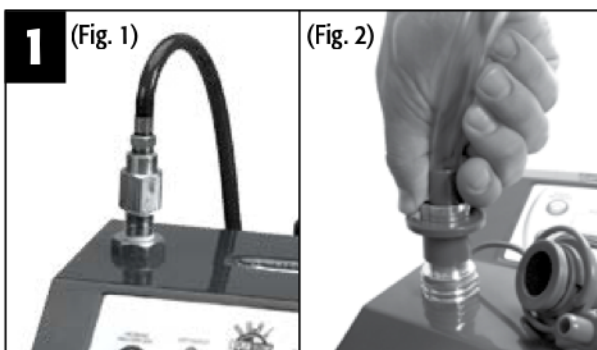

1. Dual Split-Second Sizer or Duplicator 2 Model:

Hand-tight connect the Insider Inflation Tool onto the left outlet. Set the automatic sizer to the appropriate size of balloon that will be inflated inside the large balloon. (Fig. 1)

Precision Air or Air Force 4 Model:

Remove one blue latex outlet and push the Inflation Tool onto the Friction Fit port. If using a Precision Air, set the automatic sizer to the appropriate size of balloon that will be inflated inside the large balloon. (Fig. 2)

10ft Extension Hose Inflator Model:

Connect the 10ft Extension Hose Inflator to the cylinder and attach the Snap-On Trigger Valve Outlet to the end of the 10ft Extension Hose.



2. Press the Air Hose over an outlet of the Air Force 4 (or any air blower) and turn the blower on. Place the other end of the Air Hose over the back port of the Insider Tool and fully inflate the large balloon.

Repeat this step as often as needed while performing Steps 3 and 4.



3. Stretch a balloon over the Inflation Tool and insert the tool into the back port of the Insider. Press the foot pedal to inflate or squeeze the Trigger Valve if using the 10ft Extension Hose Inflator.

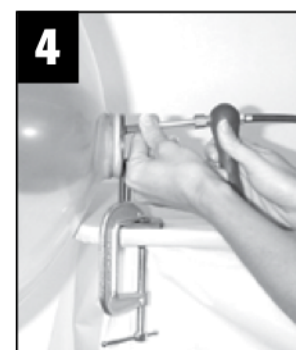

4. When the balloon is fully inflated, quickly remove the Inflation Tool and pull back on the balloon to create a seal, preventing air escaping from the large balloon. Repeat step 3 and 4 until the large balloon is fully stuffed.

Tying the Balloons



To easily tie the balloon, place two fingers on the stretched neck and rotate your hand one full revolution to create a loop with the stretched neck of the balloon. Tuck the end of the balloon neck through the top of the loop to knot the balloon. Release the neck of the balloon into the yellow flap of the Insider.



Related Products for the Insider Balloon Stuffing Tool



Dual Split-Second Sizer Inflator®

Unmatched for speed, accuracy, and efficiency, the Dual Split-Second Sizer lets you set your inflation time within tenths of a second. The hands-free foot pedal allows you to quickly inflate and tie balloons. The Dual Sizer is the most versatile inflator you'll ever own.

Item # 84501



Duplicator 2 Inflator®

The Duplicator 2 automatically inflates latex balloons at the touch of a button. The separate outlet inflates foil balloons to the right pressure and size. The Duplicator 2 can be powered by helium, nitrogen, or from an air compressor.

Item # 84200



Air Force 4 Inflator®

Featuring four outlets for fast simultaneous inflation, the Air Force 4 is a must for on-the-job decorating. The continual-air blower is designed to maintain a fixed temperature and not overheat on large jobs. The Air Force 4 is all you need for your air-filled decorating projects.

Item # 82300



Air-Pro Inflator®

The Air-Pro is ideal for fast inflation of air-filled balloons. The Air-Pro quickly and easily inflates all size balloons by pressing down on the push valve outlet. The push valve features an extension tip outlet for inflating small balloons and foil balloons. Great for retail.

Item # 86500



Precision Air Inflator®

The Precision Air automatically sizes air-filled latex balloons without the use of heavy cylinders, noisy air compressors, or time-consuming templates. Electrical unit provides digital timing to accurately size two air-filled balloons simultaneously at the touch of the foot pedal control.

Item # 83501



Balloon Bulbs®

Create brilliant decor with Balloon Bulbs. Designed by Conwin exclusively for balloon decorators, Balloon Bulbs are a perfect accent for dance floors, entrance, decor, buffet areas, or any special location indoors or out.

Item # 86801

Service & Warranty

For assistance with service & repair issues or for warranty information, please visit ConwinOnline.com, or call 1-(818)-246-9233



CONWIN
4510 Sperry Street
Los Angeles, CA 90039



© Conwin Inc. | 08212014

Online
Projects,
Designs,
Articles, Galleries
and more! Only at

ConwinOnline.com

